

Seating Plans:

The EPR I has 112 seats available for exams. Depending on which computer number is assigned to you for your exam, you will be seated in one of the four color-coded zones. You will find out which computer you have been assigned no later than 30 minutes before the exam on the notice posted in front of the exam room.

Here you can see the current seating plan for EPR I:

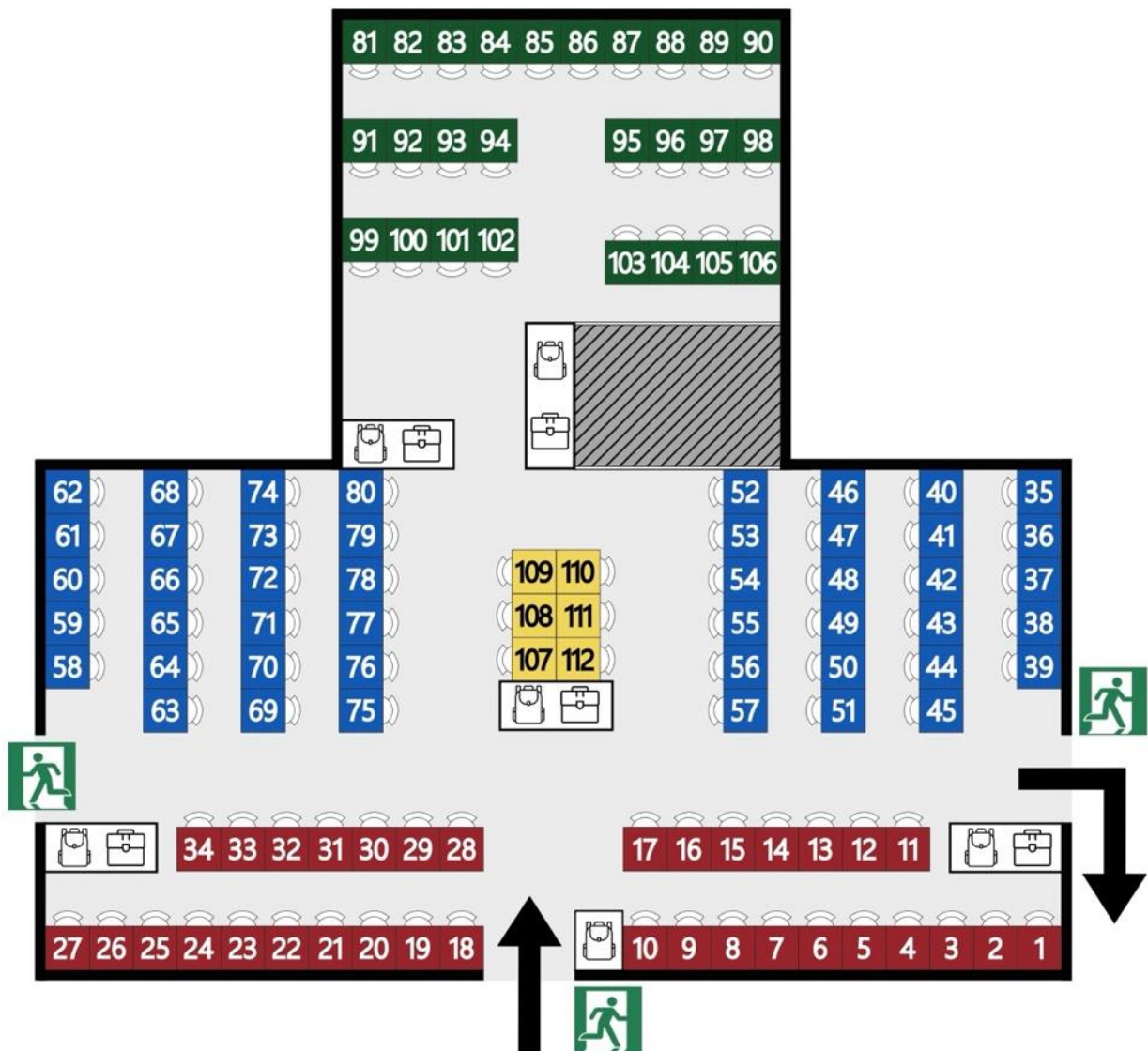

Here you can see the current seating plan for EPR II:

